

## MQ1510 Installation Instructions

1. Remove the front cover by slackening the captive screw and hinging upwards
2. Remove the PCB by pushing the PCB clip to the right and hinging the PCB upwards
3. Knock out mounting holes A for wall mount, holes B for corner mount and C for cable access. Alternatively if the bracket is to be fitted follow 3a to 3c. Mount the detector at the recommended mounting height.
4. Replace the PCB and connect as shown. Replace the front cover.

Apply 9-16Vdc and wait 1 minute to stabilize then perform a walk test.

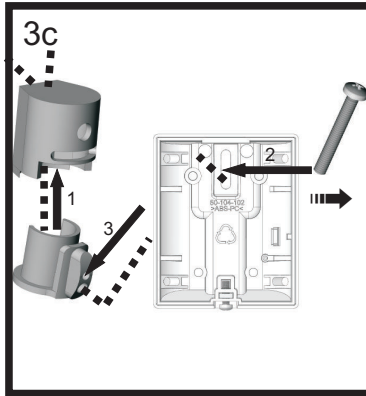
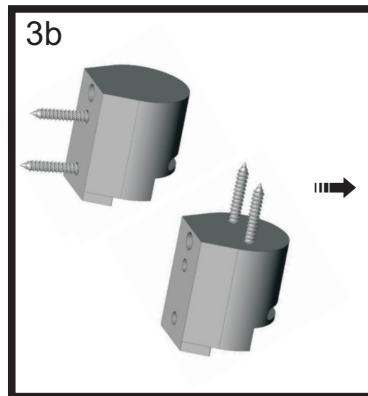
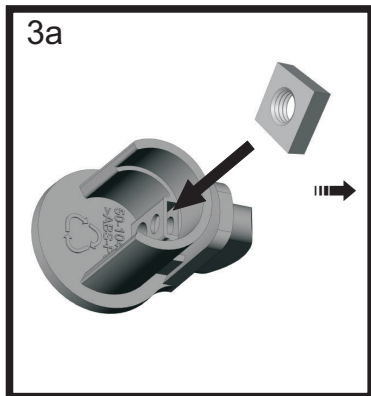
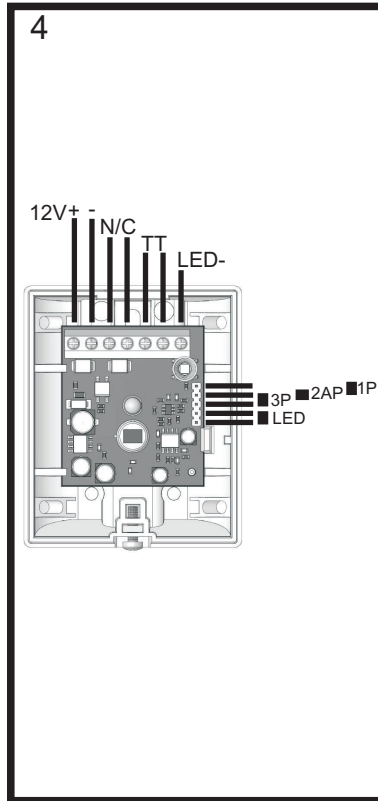
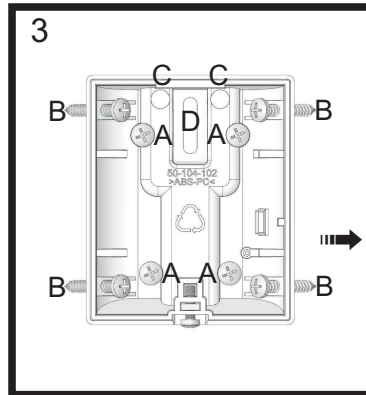
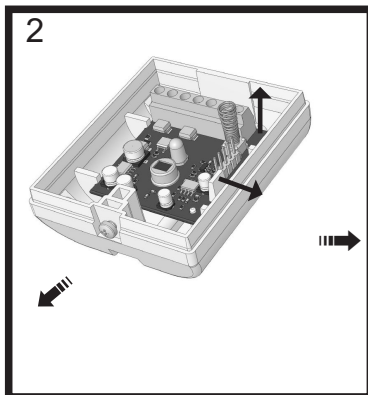
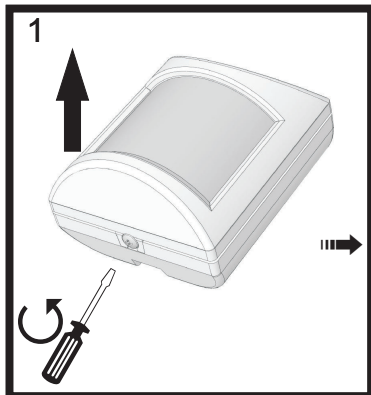

# TEMPUS

Security Products

## MQ1510

Quad Element PIR Detector



### FEATURES

High Sensitivity Quad Element Pyrosensor  
15m 110° Volumetric Range  
Digital Amplifier  
Opto Isolated Solid State Relay  
Microprocessor based Digital Pulse count 1, 2AP, 3 Jumper Selectable  
10 bit ADC  
LED Enable Input and via Jumper  
Extended Temperature Performance  
Blue LED  
Digital Signal Processing  
Bracket included

### TECHNICAL SPECIFICATION

#### COVERAGE

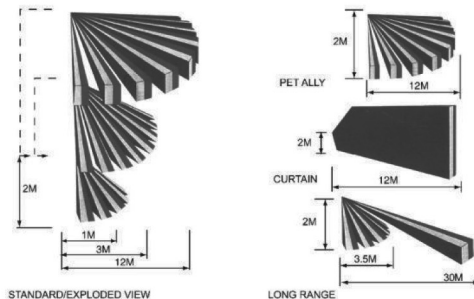

#### ELECTRICAL

Operating Voltage: 9-16VDC  
Operating Current: 6mA  
Alarm Contacts: N/C Solid State 60VDC 50mA  
Tamper: 16V 50mA maximum  
RFI Immunity: Exceeds CE requirements

Warranty: 5 years

#### OPERATION

Alarm Period: >2 seconds  
Detection Speed: 0.3 - 3ms  
Operating Temperature: -10 to +50°C  
Storage Temperature: -10 to +50°C  
Range: 15m 110° Volumetric  
Mounting Height: 2m

#### MECHANICAL

Case Material: 3mm ABS-PC  
Weight: 52g  
Product: 72mm x 59mm x 44mm

#### APPROVALS

CE Grade II Suitable for:

Residential  
Commercial  
Industrial

